



# Manhole Products

72" Type 2 Precast Catch Basin  
WSDOT B-10.20-03

### Square Risers Available

- 2", 3", 4", 6", 12", 24" Solid or w/ Knockouts

### Grade Adjustment Rings Available

- 2", 3", 4", 6"

### Hole or Knock Out Dimensions

- Maximum hole size is 60 inches
- 12 inches of minimum distance between holes
- 2 inch diameter lifting holes provided
- Cored, cast-in and custom block-out/knock-outs available

### Conformity Standards

- ASTM C478 manhole
- ASTM C443 rubber gasket joint
- ASTM D4101 polypropylene steps and ladders
- Washington State APWA / WSDOT Standard

### Options Available

- 2 foot minimum sump
- Specialized coatings
- Custom hatches
- Kor-N-Seal boots
- 1' thru 10' Polypropylene ladders
- Round offset & center hole flat tops
- Mastic

### Section Specifications

| Height | Section    | Base       |
|--------|------------|------------|
| 12"    | 1,731 LBS  | 4,737 LBS  |
| 24"    | 3,499 LBS  | 6,505 LBS  |
| 36"    | 5,266 LBS  | 8,272 LBS  |
| 48"    | 7,034 LBS  | 10,040 LBS |
| 60"    | 8,802 LBS  | 11,808 LBS |
| 72"    | 10,569 LBS | 13,575 LBS |

| Base Slab | Flat Top  |
|-----------|-----------|
| 3,757 LBS | 3,982 LBS |

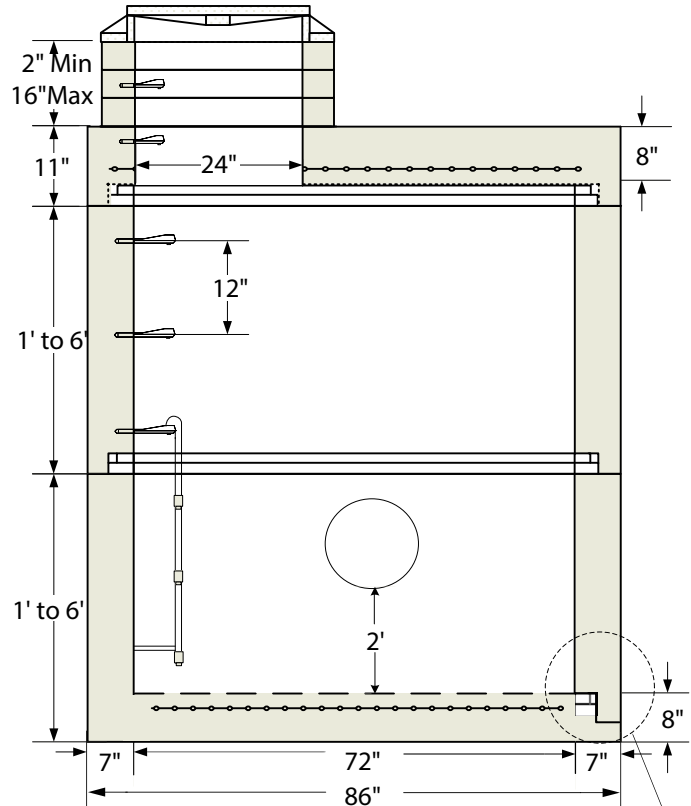

Top View

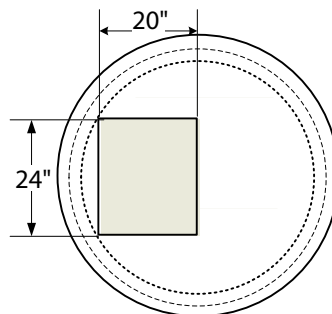

Gasket Shown Uncompressed

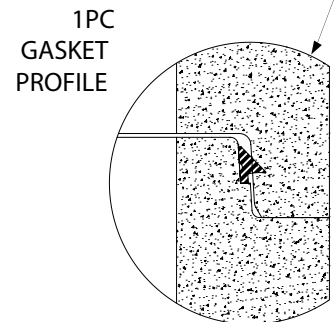

Note: Drawings not to scale

www.shopeconcrete.com

1-800-422-7560 [TOLL FREE]



Shope Concrete, LLC  
1618 East Main Avenue  
Puyallup, WA 98372-3142

(253) 848-1551  
Fax Line 1 (253) 845-0292  
Fax Line 2 (253) 864-6172

